

Name: _____

Date: _____ Per: _____

Lesson 5.1.2 Homework

5-18. A shade of orange paint is made with 5 parts red paint and 15 parts yellow paint.

- What percent of the paint is red?
- What is the simplified ratio of yellow to red paint?

5-19. Janelle earned 90% on a test and got 63 points. How many total points were possible on the test? Draw a diagram to organize your information before solving the problem.

5-20. The diagram at right is the floor plan of Randy's apartment. All measurements are in feet. Use the diagram to answer the following questions.

- What are the dimensions (length and width) of Randy's living room?
- Randy's friends are coming to visit him soon. He plans to keep them out of his bedroom. Find the area of each of the other three rooms he will have to clean.

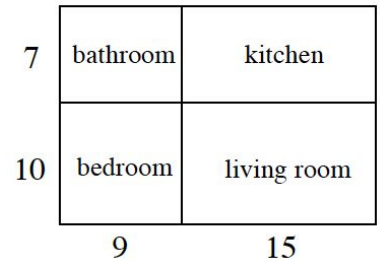

- What is the total area of the rooms he will have to clean?

5-21. Simplify each expression.

a. $-\frac{4}{5} + \frac{3}{10}$

b. $2\frac{5}{8} - 1\frac{1}{3}$

5-22. The trapezoids at right are similar shapes.

- What is the scale factor from shape A to shape B?

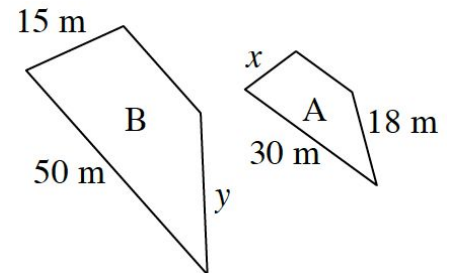

- Find the lengths of the missing sides.